

POWER OR MANUAL REWIND REELS

SERIES 2400

1/2", 3/4" or 1" Fluid Path For
1/2" through 1" I.D. Hose

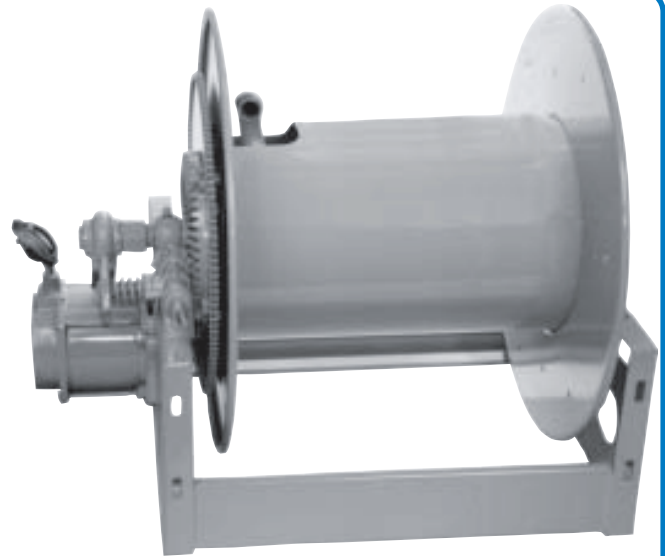

REWIND: Choose **NORDIC** gear-drive crank rewind, or chain and sprocket drive powered by A.C. or D.C. electric motor, compressed air motor or hydraulic motor.

INLET: 1/2" up to 1" female/male NPT 90° swivel joint. Straight swivel joint may be specified at extra cost.

GOOSENECK: 1/2" up to 1" female/male NPT. *Other sizes and/or threads, including male NST and male garden hose thread, can be furnished when specified.*

Product temperatures from -20° to +225°F and standard pressures to 1000 p.s.i. Reels to operate at other temperatures or pressures can be furnished at extra cost. Consult factory.

The standard color for this series is grey.

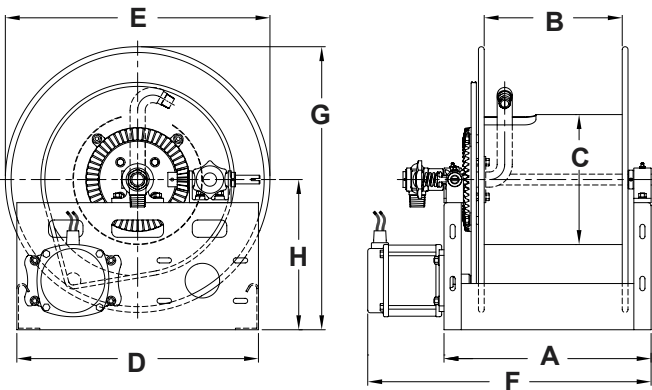

Note: Weights shown in chart are for crank rewind models.	prefix	type	lb / kg
	EP	electric	42 / 19
	A	air	26 / 12
Add these amounts and model number prefix for power rewind models.	H	hyd	26 / 12

ADD 12" to E dimension when crank is in rewind position.

I D	in	1/2	3/4	1	MODEL NO.	Reel Dimensions in Inches and <i>Millimeters</i>												Approx Net Weight		
	mm	13	19	25		A	B	C	D	E	E	E	E	F	F	F	F		G	H
	mm	7/8	1 9/32	1 9/16		CRK	ELC	AIR	HYD	CRK	ELC	AIR	HYD	CRK	ELC	AIR	HYD		G	H
Hose Capacity of Reel in Feet and Meters	ft	200	100	50	2400-19-15	21	15	11 1/4	21	21	21	21	25	28	25	27	22 1/2	13	70 LB	
	m	61	30	15		533	381	286	533	533	533	559	533	635	711	635	686	572	330	31 KG
	ft	315	150	100	2400-23-14	20	14	11 1/4	21	23	23	24	23	24	27	24	26	24 1/2	13	74 LB
	m	96	46	30		508	356	286	533	584	584	610	584	610	686	610	660	622	330	34 KG
	ft	485	240	150	2400-23-18	24	18	11 1/4	21	23	23	24	23	28	31	28	30	24 1/2	13	78 LB
	m	148	73	46		610	457	286	533	584	584	610	584	711	787	711	762	622	330	35 KG
	ft	535	260	165	2400-23-20	26	20	11 1/4	21	23	23	24	23	30	33	30	32	24 1/2	13	80 LB
	m	163	79	50		660	508	286	533	584	584	610	584	762	838	762	813	622	330	36 KG
	ft	625	300	200	2400-23-24	30	24	11 1/4	21	23	23	24	23	34	37	34	36	24 1/2	13	84 LB
	m	191	91	61		762	610	286	533	584	584	610	584	864	940	864	914	622	330	38 KG
	ft	235	125	60	2400-25-8	14	8	11 1/4	21	25	25	25	25	18	21	18	20	26 1/2	14	72 LB
	m	72	38	18		356	203	286	533	635	635	635	635	457	533	457	508	673	356	33 KG
	ft	450	225	110	2400-25-14	20	14	11 1/4	21	25	25	25	25	24	27	24	26	26 1/2	14	74 LB
	m	137	69	34		508	356	286	533	635	635	635	635	610	686	610	660	673	356	34 KG
	ft	435	185	125	2400-31-8	14	8	11 1/4	21	31	31	31	31	18	21	18	20	32 1/2	17	74 LB
	m	133	56	38		356	203	286	533	787	787	787	787	457	533	457	508	826	432	34 KG
	ft	540	235	165	2400-31-10	16	10	11 1/4	21	31	31	31	31	20	23	20	22	32 1/2	17	76 LB
	m	165	72	50		406	254	286	533	787	787	787	787	508	584	508	559	826	432	35 KG
	ft	900	400	300	2400-31-16	22	16	11 1/4	21	31	31	31	31	26	29	26	28	32 1/2	17	80 LB
	m	274	122	91		559	406	286	533	787	787	787	787	660	737	660	711	826	432	36 KG